

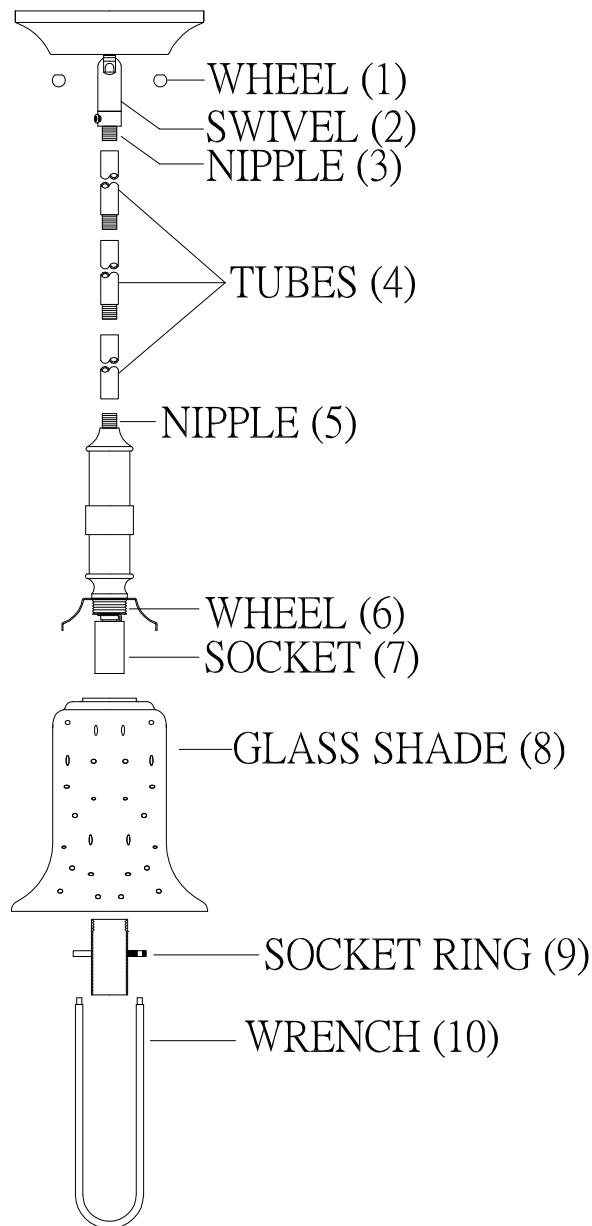

## LIGHTING

ITEM NO: 7-9135-1-13

7-9135-1-SN



### INSTALLATION INSTRUCTIONS

1. Carefully remove the fixture out of the carton, and check that all parts are included referring to the above illustration. Make sure not to misplace any parts that are needed for the installation;
2. Assemble the tubes (4) together using the nipple (3), then attach the bottom end of tubes (4) onto the nipple (5) tightly, then screw the tubes (4) into the nipple (5).
3. Install the swivel (2) onto tubes (4), then screw them with swivel (2).
4. Install the glass shade (8) and socket ring (9) onto wheel (7), then screw them with socket ring (7) using the wrench (10).
5. Fixture is ready for lamping and installation.